

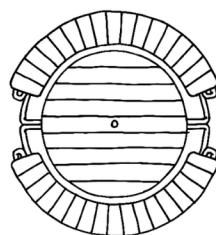

## ANCHORING INSTRUCTIONS



## ANCHORING THE TABLE THE CIRCLE THE BOW

## INFORMATION

- This ground anchor can be used for fixing The Table / The Circle to a solid surface such as concrete or paving.
- The anchor does not preclude theft.

## TOOLS

- Stone drill 8 mm
- Hammer
- Wrench 13 mm

## CONTACT

Do you have any questions, comments or suggestions about a product or our website? Do not hesitate to contact us.

Wünder – Ovenhoek 5, 8800 Roeselare, Belgium  
+32 (0) 51 79 17 31 – [info@wunder.be](mailto:info@wunder.be)

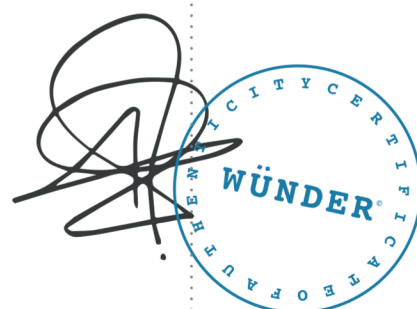

01

- The Table / The Circle anchoring set

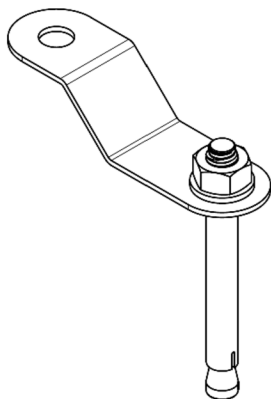

02

- Fix the stainless steel bracket to the levelling foot

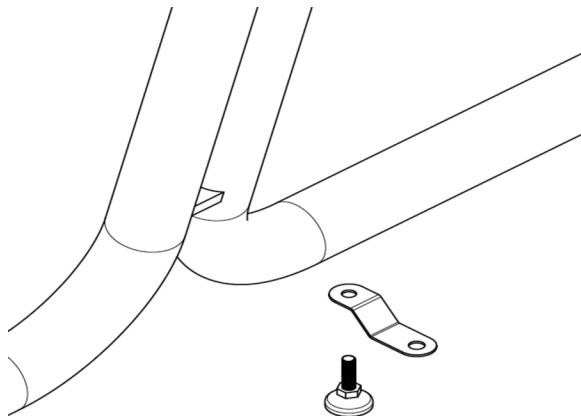

03

- Mark where the hole should be drilled

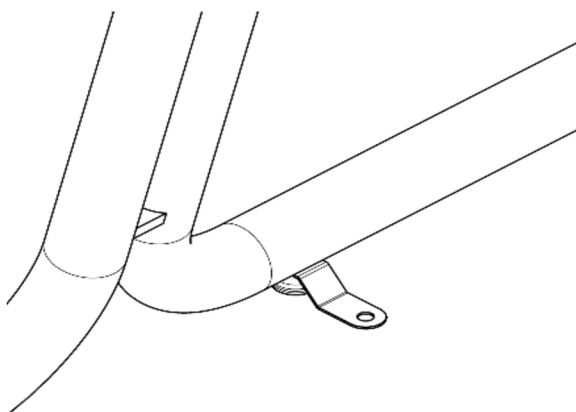

04

- Drill an 8 mm hole in the solid surface

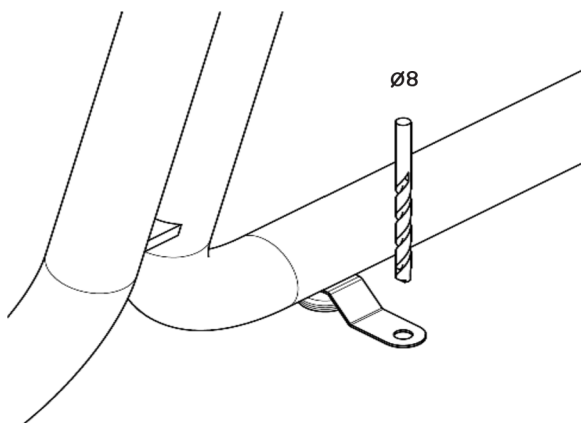

05

- Tap the concrete anchor into the ground with a hammer

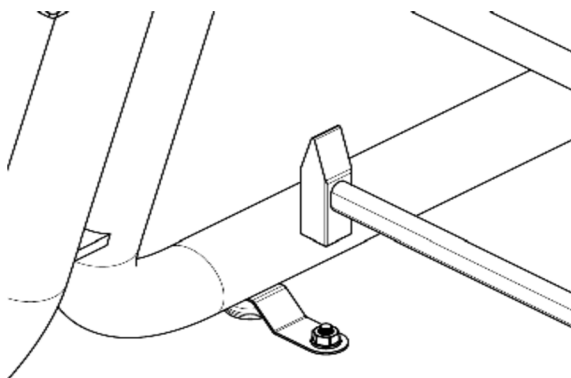

06

- Tighten the ground anchor securely

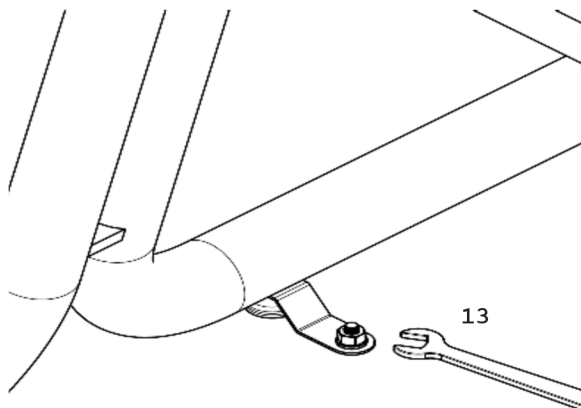

**Important:**

The actual dimensions may differ slightly from these theoretical dimensions. Make sure The Table is at its final position before you start drilling holes in the surface.

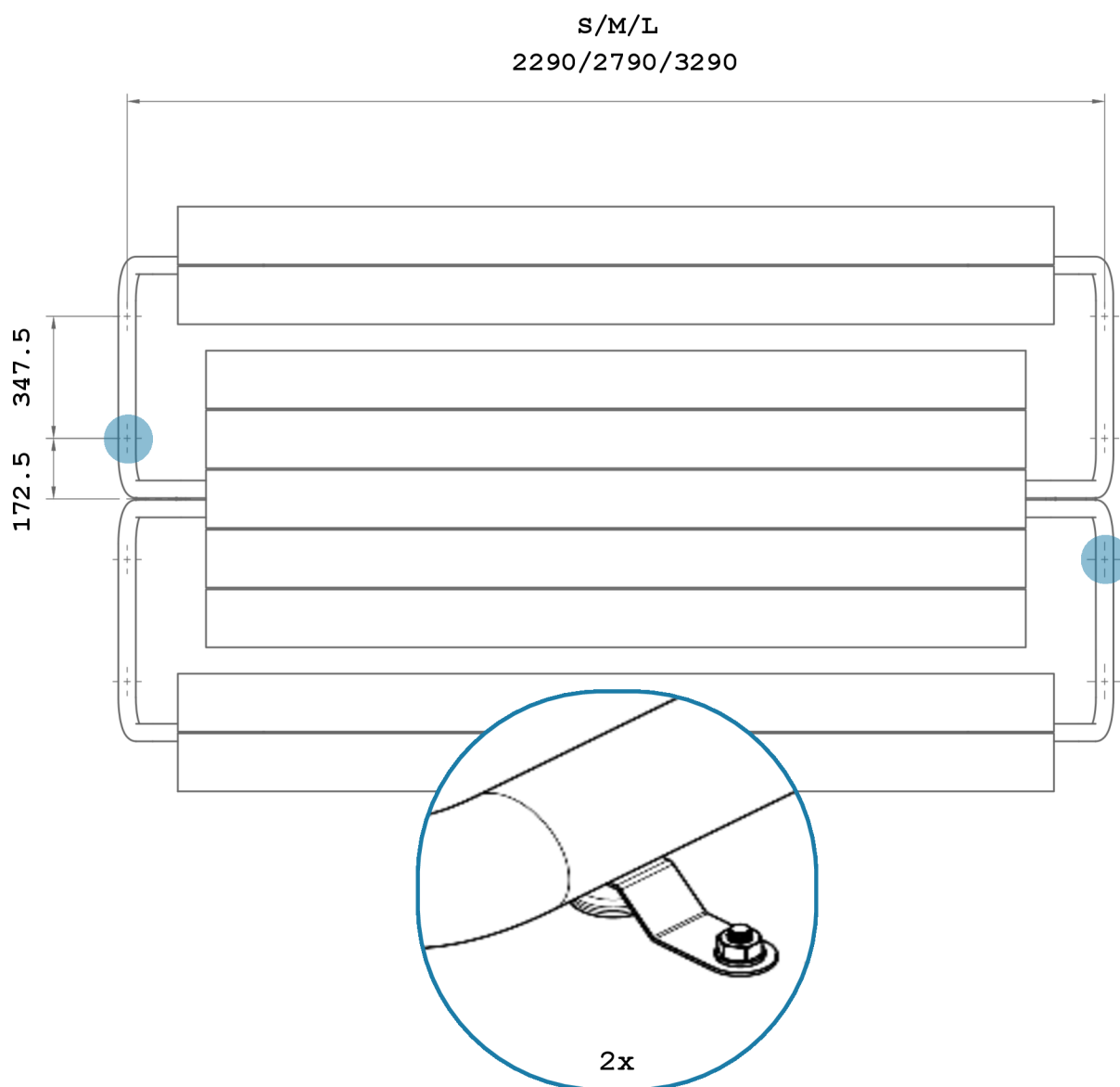

**Important:**

The actual dimensions may differ slightly from these theoretical dimensions. Make sure The Circle is at its final position before you start drilling holes in the surface.

